

# KODIAK

ULTIMATE

## TRAVEL TRAILERS



Free To Roam.

THE SOUL OF RVING





**Each new day brings wonderment. The  
opportunity to discover something new.  
To pursue your dreams and fill your soul.  
This is the Soul of RVing.**

# MORE STANDARD FEATURES MORE VALUE

Everything we put into our innovative floorplans are designed to maximize storage and comfort. We don't stop there, to ensure peace of mind after the purchase we have the industry's best RV warranty, 100% pre-delivery inspection, and the leader in parts and service. While other manufacturers offer features as options, we prefer to make those same features standard.

We've built a reputation for bringing RV owners more standard features for less money for over 35 years, and it's a reputation we plan to keep.



## 100% Pre-Delivery Inspection

At Dutchmen, quality is standard. Every single RV that comes off the line receives it's own pre-delivery inspection—a thorough 253-point check to ensure accurate measurements, as well as fully-functional electronics and components.



## The Industry's Best RV Warranty

Our industry-best 3 Year Warranty means you don't have to wrangle over the details. We deliver value by clearly outlining the major components we back for the first three years.



## The Leader In Parts & Service

Replacement parts. Routine checkups. Expert advice. We've got it all covered. When only the best RV services will suffice, our industry-leading parts and service department is ready to help you get back on the road—and stay there longer than ever before.

**Tow Vehicle Disclaimer.** CAUTION: Owners of Dutchmen recreational vehicles are solely responsible for the selection and proper use of tow vehicles. All customers should consult with a motor vehicle manufacturer or their dealer concerning the purchase and use of suitable tow vehicles for Dutchmen products. Dutchmen disclaims any liability or damages suffered as a result of the selection, operation, use or misuse of a tow vehicle. DUTCHMEN'S LIMITED WARRANTY DOES NOT COVER DAMAGE TO THE RECREATIONAL VEHICLE OR THE TOW VEHICLE AS A RESULT OF THE SELECTION, OPERATION, USE OR MISUSE OF THE TOW VEHICLE. REFERENCE DUTCHMEN MANUFACTURING OWNERS MANUAL FOR LIMITED WARRANTY DETAILS. © 2022 Dutchmen 9-17-2022-Kodiak Ultimate Model Year 2023



Dutchmen began in 1988, this model year we are celebrating our 35th Anniversary. Our long term success comes from never losing focus on our core mission "We work for the customer".

At Dutchmen we build a variety of floorplans to meet the needs of your family and lifestyle. More people than ever before are embracing the RV lifestyle, whether they are full timers, weekend warriors or just want to take the road less traveled and boondock.

Everything we put into our Kodiak is designed not only to help you hit the road in comfort and style, but to also help you make memories with family, friends, and fellow travelers along the way.

You will have peace of mind knowing we have OVER 300 Strong Nationwide Dealer Network across North America and our industry-leading service center in Goshen, Indiana. So rest assured no matter where your travels take you, the best-resourced RV manufacturing company in the world is behind you all the way.

As each new day unfolds and limitless adventure awaits, Rving is about immersing yourself in laughter and storytelling with family and friends around the campfire. For 35 years Dutchmen has been in the business of making memories. This is the Soul of the RV.

# 35 YEARS ANNIVERSARY PACKAGE

**Standard on ALL Floorplans**



The SOLO ONE Control allows complete control over many of your RV's most important functions through a mobile app. From awnings and lighting, water tanks, and more with just a touch of a button.



#### **SAFETY**

Receive custom notifications regarding your RV maintenance reminders and system status.



#### **CONTROL**

Conveniently control your lighting, slide-outs, and awnings from the palm of your hand.



#### **ALERTS**

Receive system status, low battery voltage, and tank levels.

**SOLO**  
**ONE**Control

#### **KEYLESS ENTRY**



#### **ON-DEMAND TANKLESS WATER HEATER**



#### **SLIDE-OUT TOPPERS**



#### **REAR VIEW MONITOR CAMERA**





# CONNECTION



| KODIAK ULTIMATE





**Destination: Kodiak Ultimate.** Take the scenic route as your free to roam in the Kodiak Ultimate. The leader in lightweight technology with its aluminum super-structure design. The Kodiak Ultimate is feature rich in amenities with modern design touches, including a farm-style kitchen sink, underbelly LED lights, and a King Size bed in every floorplan.

- **Composite Floor Construction** - a wood-free flooring system to provide a lighter more durable structure.
- **Fully Enclosed Underbelly** - all of your RVs vital functions are kept out of the elements. Plus, this extra layer of protection means you can travel further into the year.
- **Aluminum Steps** - stability you need when coming and going from your Kodiak Ultimate. Easy to expand and store away, these aluminum steps deliver a sound platform.
- **Fiberglass Front Cap with w/Automotive Windshield** - easy maintenance and enhanced safety.
- **Light Weight Laminated Construction** - all aluminum frame construction with laminated components for the lightest weights in it's class.
- **No Carpet** - Easy to clean, durable and pet friendly.
- **King Size Bed** -largest bed in its class.



To see more features,  
visit [dutchmen.com](http://dutchmen.com)

## Standard features in every floor plan.



Power  
Stabilizer Jacks



Power Tongue  
Jack



Fireplace



Max Air  
Vent



USB  
Ports



Prepped for  
WIFI 4G LTE



King Bed



KODIAK ULTIMATE



To see more features,  
visit [dutchmen.com](https://dutchmen.com)





FEEL AT HOME FROM THE  
FIRST MOMENT.



| KODIAK ULTIMATE



## Interior Features:

With spacious floor plans and all the amenities of home,

- King Bed
- Seamless Countertops
- Oversized Farm Style Single Bowl Sink
- High Rise Pull Out Faucet
- 3 Burner Range w/Glass Cover
- 10 cu. ft. 12V Refrigerator (Optional 8 cu. ft. Gas/Electric Refrigerator)
- Maxx Air Vent w/ Rain Sensor
- Large Drawers Under Dinette Booth
- 2 Fireplaces (N/A 3321BHSL, 3301BHSL)
- Roller Shades
- LED Interior Lighting
- Optional Free Standing Table & Chairs
- HOME Series Interior Decor Custom Collection
- Washer/Dryer Prep \*



Carbon



Savannah



Flooring



Woodgrain

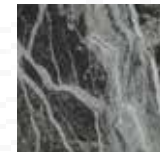

Countertop

\*Select Models

# Choose how your next adventure unfolds.



**KODIAK ULTIMATE 2921FKDS**  
Length: 33' 8" Weight: 6,554 lbs. Sleeps: 3-4  
Hitch: 782 lbs. Height: 10' 9"



**KODIAK ULTIMATE 3021RBDS**  
Length: 34' 6" Weight: 6,741 lbs. Sleeps: 3-4  
Hitch: 949 lbs. Height: 11' 2"



**KODIAK ULTIMATE 3221RLSL**  
Length: 36' 11" Weight: 7,623 lbs. Sleeps: 4-6  
Hitch: 1,051 lbs. Height: 11' 2"

\*Length is defined as the distance from the centerline of hitch pin/coupler to rear bumper of trailer.

\*\*Our weights represent how most units are built, inclusive of many commonly-ordered options.

\*\*\*Fresh water capacity includes water heater capacity.

DISCLAIMER: Product information is as accurate as possible as of the date of brochure publication. All features, floor plans and specifications in this brochure are subject to change without notice. Please consult Dutchmen's website at [www.Dutchmen.com](http://www.Dutchmen.com) for current product information and specifications.



All info & specs are for units  
manufactured after 9/3/2022



## Choose how your next adventure unfolds.



**KODIAK ULTIMATE 3301BHSL**  
Length: 37' 3" Weight: 7,195 lbs. Sleeps: 4-6  
Hitch: 892 lbs. Height: 11' 2"



**KODIAK ULTIMATE 3321BHSL**  
Length: 37' 3" Weight: 7,368 lbs. Sleeps: 8-10  
Hitch: 894 lbs. Height: 11' 2"



**KODIAK ULTIMATE 3371FLSL**  
Length: 37' 3" Weight: 7,564 lbs. Sleeps: 3-4  
Hitch: 1,109 lbs Height: 11' 2"

\*Length is defined as the distance from the centerline of hitch pin/coupler to rear bumper of trailer.

\*\*Our weights represent how most units are built, inclusive of many commonly-ordered options.

\*\*\*Fresh water capacity includes water heater capacity.

DISCLAIMER: Product information is as accurate as possible as of the date of brochure publication. All features, floor plans and specifications in this brochure are subject to change without notice. Please consult Dutchmen's website at [www.Dutchmen.com](http://www.Dutchmen.com) for current product information and specifications.



All info & specs are for units  
manufactured after 9/3/2022

# Kodiak Ultimate Specifications

Floorplan	Weights (lbs)			Tanks (Gallons)			Dimensions	
	Shipping Weight	Hitch Weight	Carrying Capacity	Fresh Water Capacity	Waste Water Capacity	Gray Water Capacity	Exterior Length	Exterior Height
2921FKDS	6,554	782	3,126	44	28	78	33' 8"	10' 9"
3021RBDS	6,741	949	2,939	44	28	78	34' 6"	11' 2"
3221RLSL	7,623	1,051	2,057	44	28	78	36' 11"	11' 2"
3301BHSL	7,195	892	2,485	44	56	78	37' 3"	11' 2"
3321BHSL	7,449	904	2,575	44	28	78	37' 3"	11' 2"
3371FLSL	7,564	1,109	2,116	44	28	78	37' 3"	11' 2"

## Mandatory Features:

- Power Tongue Jack
- Heated & Enclosed Underbelly
- Power Awning w/ LED Lights
- Black Tank Flush
- Hybrid Aluminum Step
- Aluminum Wheels
- Power Stabilizer Jacks w/ LED Lights
- LED TV

\*Length is defined as the distance from the centerline of hitch pin/coupler to rear bumper of trailer.

\*\*Our weights represent how most units are built, inclusive of many commonly-ordered options.

\*\*\*Fresh water capacity includes water heater capacity.

DISCLAIMER: Product information is as accurate as possible as of the date of brochure publication. All features, floor plans and specifications in this brochure are subject to change without notice. Please consult Dutchmen's website at [www.Dutchmen.com](http://www.Dutchmen.com) for current product information and specifications.



All info & specs are for units manufactured after 9/3/2022





CRAFTED FOR  
YOUR LIFESTYLE



| KODIAK ULTIMATE





## Exterior Features:

- Bear Cage Construction
- Laminated Crowned Roof
- Solar Prep
- Spare Tire
- Outside TV Hook Up & Mount
- Automotive Windshield
- Underbelly LED Lights
- LED Exterior Lights
- Outside Kitchen\*
- Outside Shower
- 13,500 BTU A/C (Option 15K)
- 50 AMP Service w/ Second A/C Prep
- External Power Box with Battery Disconnect
- Suburban Griddle w/ Bracket



\*Select floor plans



To see more features,  
visit [dutchmen.com](http://dutchmen.com)

| KODIAK ULTIMATE

# See the DUTCHMEN® Construction Advantage.

We put a great amount of thought into every RV we design and build. From strong frames, to sturdy walls and insulation, we build every RV to take you on many adventures to come.

## Laminated Walls

- 1 Fiberglass Exterior Panel
- 2 Lauan Wall Backing
- 3 Aluminum Frame with Block Foam Insulation
- 4 Lauan Interior Wall Panel

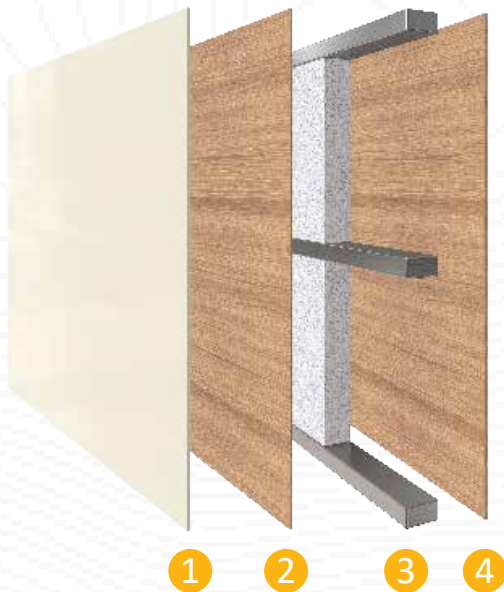

## HyperDeck Flooring

- 1 Linoleum Flooring
- 2 Fiberglass Reinforced Polypropylene
- 3 Higher Density Form Core
- 4 Fiberglass Reinforced Thermoplastic Base Layer
- 5 Steel Powder Coated Main Frame
- 6 Fully Enclosed Underbelly

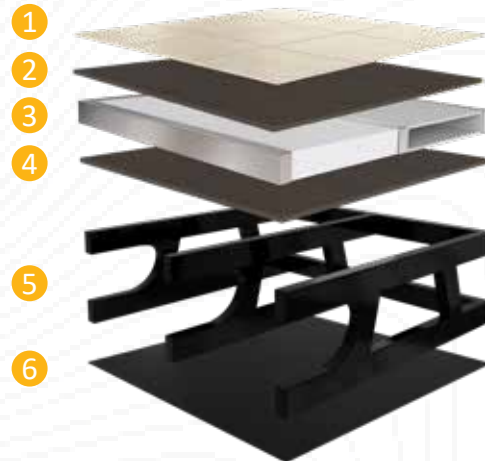

## Insulated Reinforced Front Cap

- 1 Lauan Interior Panel
- 2 Aluminum Frame with Fiberglass Insulation
- 3 Fiberglass Front Cap

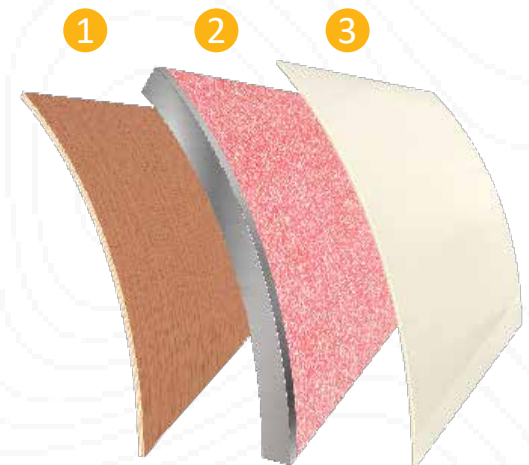

 To see more features, visit [dutchmen.com](http://dutchmen.com)





## Make the DUTCHMEN® Connection.

Connect with other RVers in the Dutchmen community. Sharing adventures is a great way to get inspired and get on the road. Gather 'round our social media campfires with us—and be sure to follow us so we can share with you!

[dutchmen.com](https://dutchmen.com)



Visit us online to see all the Dutchmen brands, innovative models, and spacious floor plans.

CONTACT SALES: 574.537.0600

PO BOX 2000 | 2164 CARAGANA COURT | GOSHEN, IN 46527