

KODIAK CUB



TRAVEL TRAILERS



Free To Roam.



THE SOUL OF RVING

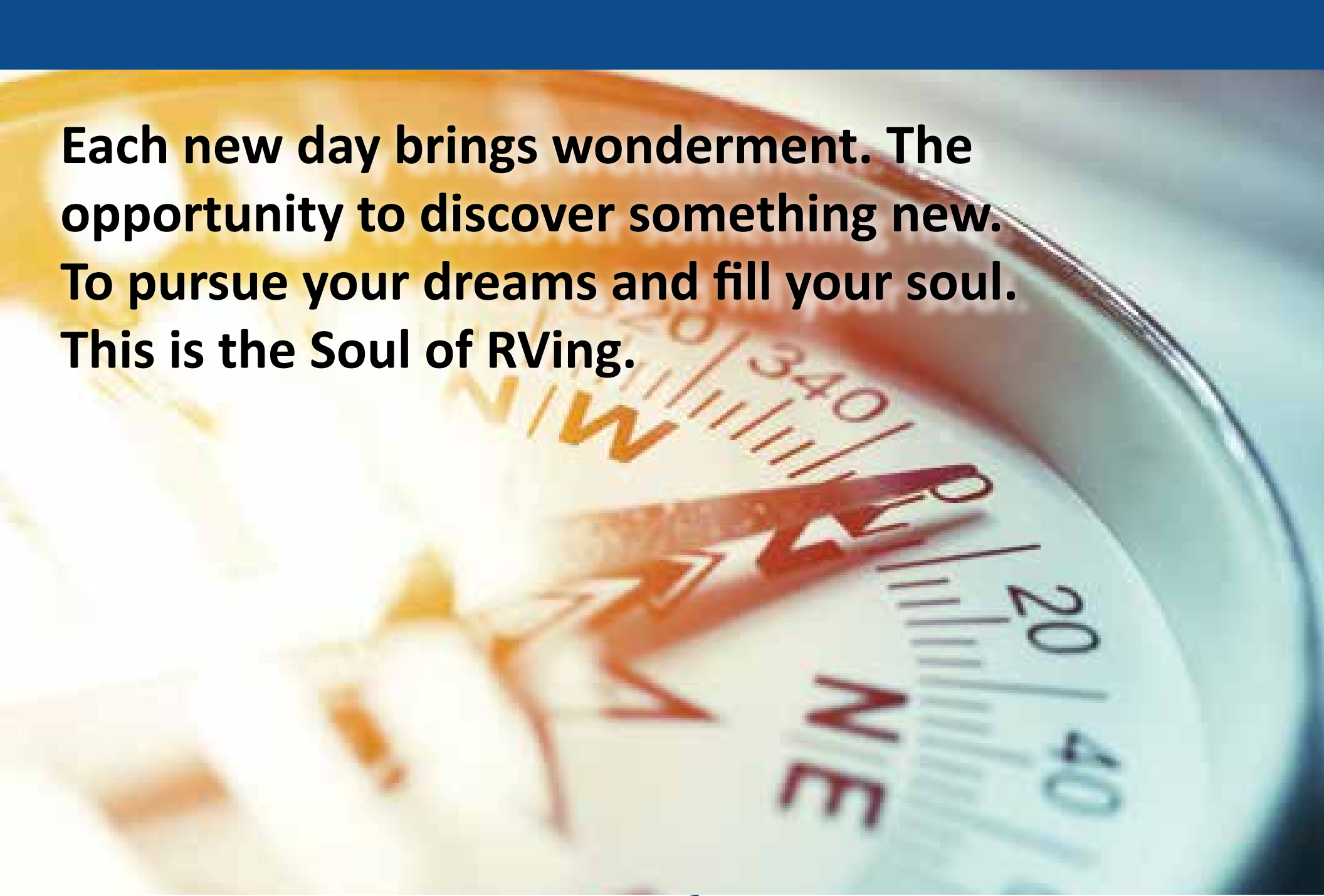

Each new day brings wonderment. The opportunity to discover something new. To pursue your dreams and fill your soul. This is the Soul of RVing.

MORE STANDARD FEATURES MORE VALUE

Everything we put into our innovative floorplans are designed to maximize storage and comfort. We don't stop there, to ensure peace of mind after the purchase we have the industry's best RV warranty, 100% pre-delivery inspection, and the leader in parts and service. While other manufacturers offer features as options, we prefer to make those same features standard.

We've built a reputation for bringing RV owners more standard features for less money for over 35 years, and it's a reputation we plan to keep.



100% Pre-Delivery Inspection

At Dutchmen, quality is standard. Every single RV that comes off the line receives its own pre-delivery inspection—a thorough 253-point check to ensure accurate measurements, as well as fully-functional electronics and components.



The Industry's Best RV Warranty

Our industry-best 3 Year Warranty means you don't have to wrangle over the details. We deliver value by clearly outlining the major components we back for the first three years.



The Leader In Parts & Service

Replacement parts. Routine checkups. Expert advice. We've got it all covered. When only the best RV services will suffice, our industry-leading parts and service department is ready to help you get back on the road—and stay there longer than ever before.

Tow Vehicle Disclaimer. CAUTION: Owners of Dutchmen recreational vehicles are solely responsible for the selection and proper use of tow vehicles. All customers should consult with a motor vehicle manufacturer or their dealer concerning the purchase and use of suitable tow vehicles for Dutchmen products. Dutchmen disclaims any liability or damages suffered as a result of the selection, operation, use or misuse of a tow vehicle. DUTCHMEN'S LIMITED WARRANTY DOES NOT COVER DAMAGE TO THE RECREATIONAL VEHICLE OR THE TOW VEHICLE AS A RESULT OF THE SELECTION, OPERATION, USE OR MISUSE OF THE TOW VEHICLE. REFERENCE DUTCHMEN MANUFACTURING OWNERS MANUAL FOR LIMITED WARRANTY DETAILS. © 2022 Dutchmen 10-17-2023 Kodiak Cub Model Year 2023



Dutchmen[®]

35TH ANNIVERSARY

Dutchmen began in 1988, this model year we are celebrating our 35th Anniversary. Our long term success comes from never losing focus on our core mission “We work for the customer”.

At Dutchmen we build a variety of floorplans to meet the needs of your family and lifestyle. More people than ever before are embracing the RV lifestyle, whether they are full timers, weekend warriors or just want to take the road less traveled and boondock.

Everything we put into our Kodiak is designed not only to help you hit the road in comfort and style, but to also help you make memories with family, friends, and fellow travelers along the way.

You will have peace of mind knowing we have OVER 300 Strong Nationwide Dealer Network across North America and our industry-leading service center in Goshen, Indiana. So rest assured no matter where your travels take you, the best-resourced RV manufacturing company in the world is behind you all the way.

As each new day unfolds and limitless adventure awaits, Rving is about immersing yourself in laughter and storytelling with family and friends around the campfire. For 35 years Dutchmen has been in the business of making memories. This is the Soul of the RV.

 | KODIAK CUB



CONNECTION



| KODIAK CUB



Destination: Kodiak Cub. Take the scenic route as your free to roam in the Kodiak Cub. The leader in lightweight technology with its aluminum super-structure design. The Kodiak Cub is feature rich in amenities with modern design touches.

- **Composite Floor Construction** - a wood-free flooring system to provide a lighter more durable structure.
- **Torsion Axle** - advanced rubberized suspension provides a smoother ride and an extra 3" of ground clearance.
- **Off-Road Aluminum Wheel & Tire Package** - the destination isn't always paved.
- **Fully Enclosed Underbelly** - all of your RVs vital functions are kept out of the elements. Plus, this extra layer of protection means you can travel further into the year.
- **Aluminum Steps** - stability you need when coming and going from your Kodiak Cub. Easy to expand and store away, these aluminum steps deliver a sound platform.
- **Fiberglass Front Cap with LED Lights** - easy maintenance and enhanced durability.
- **Light Weight Laminated Construction** -all aluminum frame construction with laminated components for the lightest weights in its class.



To see more features,
visit dutchmen.com

35 YEARS ANNIVERSARY PACKAGE

Standard on ALL Floorplans



The SOLO ONE Control allows complete control over many of your RV's most important functions through a mobile app. From awnings and lighting, water tanks, and more with just a touch of a button.



SAFETY

Receive custom notifications regarding your RV maintenance reminders and system status.



CONTROL

Conveniently control your lighting, slide-outs, and awnings from the palm of your hand.



ALERTS

Receive system status, low battery voltage, and tank levels.

SOLO
ONE Control

KEYLESS ENTRY



ON-DEMAND TANKLESS WATER HEATER



SLIDE-OUT TOPPERS



REAR VIEW MONITOR CAMERA



Standard features in every floorplan.



Power Stabilizer Jacks



Power Tongue Jack



Dual 20lb Propane Tanks



Motion Sensor LED Lighting



USB Ports



Prepped for WIFI 4G LTE



Queen Bed





**FEEL AT HOME FROM THE
FIRST MOMENT.**



| KODIAK CUB



Interior Features:

With spacious floor plans and all the amenities of home,

- LED Interior & Exterior Lighting
- Stainless Steel Appliances
- 2 Burner Range w/ Glass Cover
- One Piece Seamless Countertops
- Large Kitchen Sink w/ High Rise Faucet
- 12V 10 cu. ft Refrigerator with 8 cu. ft. Gas/ Electric Refrigerator Option
- Roller Shades
- 6 Gallon Gas Water Heater
- Maxx Air Vent w/ Rain Sensor
- LED Lit Medicine Cabinet
- HOME Series - Interior Design Custom Collection

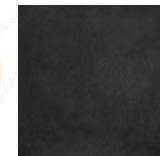

Carbon



Savannah



Flooring



Woodgrain



Countertop

Choose how your next adventure unfolds.



KODIAK CUB 175BH
Length: 21' 5" Weight: 3,630 lbs. Sleeps: 3-4
Hitch: 444 lbs. Height: 10' 7"



KODIAK CUB 177RB
Length: 21' 5" Weight: 3,368 lbs. Sleeps: 3-4
Hitch: 394 lbs. Height: 10' 7"



KODIAK CUB 196BH
Length: 23' 8" Weight: 4,155 lbs. Sleeps: 3-4
Hitch: 464 lbs. Height: 10' 7"



KODIAK CUB 199RK
Length: 23' 11" Weight: 4,264 lbs. Sleeps: 3-4
Hitch: 540 lbs. Height: 10' 7"

*Length is defined as the distance from the centerline of hitch pin/coupler to rear bumper of trailer.

**Our weights represent how most units are built, inclusive of many commonly-ordered options.

***Fresh water capacity includes water heater capacity.

DISCLAIMER: Product information is as accurate as possible as of the date of brochure publication. All features, floor plans and specifications in this brochure are subject to change without notice. Please consult Dutchmen's website at www.Dutchmen.com for current product information and specifications.



All info & specs are for units manufactured after 9/3/2022

Kodiak Cub Specifications

Floorplan	Weights (lbs)			Tanks (Gallons)			Dimensions	
	Shipping Weight	Hitch Weight	Carrying Capacity	Fresh Water Capacity	Waste Water Capacity	Gray Water Capacity	Exterior Length	Exterior Height
175BH	3,630	444	1,870	44	28	39	21' 5"	10' 7"
177RB	3,638	394	1,862	44	28	39	21' 5"	10' 7"
196BH	4,155	464	1,345	44	28	39	23' 8"	10' 7"
199RK	4,264	540	1,236	44	28	39	23' 11"	10' 7"

Mandatory Features:

- Black Tank Flush
- Heated & Enclosed Underbelly
- Power Awning w/ LED Lights
- All-Terrain Tires & Wheels
- Hybrid Aluminum Step
- Torsion Axle
- Power Stabilizer Jacks w/ LED Lights



*Length is defined as the distance from the centerline of hitch pin/coupler to rear bumper of trailer.

**Our weights represent how most units are built, inclusive of many commonly-ordered options.

***Fresh water capacity includes water heater capacity.

DISCLAIMER: Product information is as accurate as possible as of the date of brochure publication. All features, floor plans and specifications in this brochure are subject to change without notice. Please consult Dutchmen's website at www.Dutchmen.com for current product information and specifications.



All info & specs are for units manufactured after 9/3/2022



Exterior Features:

- Solar Power Prep
- Aluminum Framing
- Laminated Crowned Roof
- Underbelly LED Lights
- Front Diamond Plate Protection
- Aluminum Spare Tire
- Outside TV Hook Up & Mount
- 120V Exterior Outlet
- 30 Amp Detachable Marine Power Cord
- 35 Amp Converter
- 13,500 BTU A/C
- Rear Ladder Prep
- Suburban Griddle w/ Bracket*

EXTERIOR GRIDDLE
(SELECT FLOORPLANS)



DEXTER TORSION AXLE



**EXT. POWER BOX W/
BATTERY DISCONNECT**



*Select Floorplans

 To see more features, visit dutchmen.com

See the DUTCHMEN® Construction Advantage.

We put a great amount of thought into every RV we design and build. From strong frames, to sturdy walls and insulation, we build every RV to take you on many adventures to come.

Laminated Walls

- 1 Fiberglass Exterior Panel
- 2 Lauan Wall Backing
- 3 Aluminum Frame with Block Foam Insulation
- 4 Lauan Interior Wall Panel

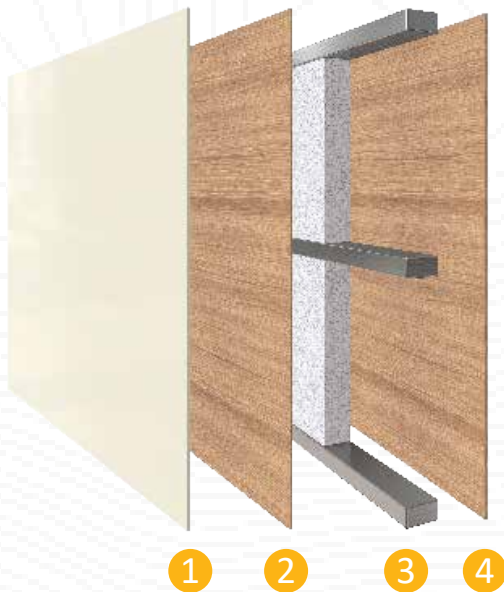

HyperDeck Flooring

- 1 Linoleum Flooring
- 2 Fiberglass Reinforced Polypropolene
- 3 Higher Density Form Core
- 4 Fiberglass Reinforced Thermoplastic Base Layer
- 5 Steel Powder Coated Main Frame
- 6 Fully Enclosed Underbelly



Insulated Reinforced Front Cap

- 1 Lauan Interior Panel
- 2 Aluminum Frame with Fiberglass Insulation
- 3 Fiberglass Front Cap



 To see more features, visit dutchmen.com



Make the DUTCHMEN® Connection.

Connect with other RVers in the Dutchmen community. Sharing adventures is a great way to get inspired and get on the road. Gather 'round our social media campfires with us—and be sure to follow us so we can share with you!

dutchmen.com



Visit us online to see all the Dutchmen brands, innovative models, and spacious floor plans.

CONTACT SALES: 574.537.0600

PO BOX 2000 | 2164 CARAGANA COURT | GOSHEN, IN 46527