

ASPEN TRAIL

WEST COAST

Aspen Trail has the most dynamic range of floor plan options to fit any camping style. With more standard features than its competitors and a focus on quality, value, and design, Aspen Trail delivers the best RV in its class. Whether your trail leads across this great country or simply a staycation, with Aspen Trail make every journey your own.

- **Aspen Trail Power Package** - Aspen Trail Power Stabilizers, Power Awning and Power Tongue Jack make setting up and breaking down your campsite a breeze.
- **Fully Enclosed Underbelly** - all of your RVs vital functions are kept out of the elements. Plus, this extra layer of protection means you can travel further into the year.
- **Aluminum Steps** - stability you need when coming and going from your Aspen Trail. Easy to expand and store away, these aluminum steps deliver a sound platform.



35 YEARS ANNIVERSARY PACKAGE

<p>Solo OneControl</p> 	<p>On-Demand Tankless Water Heater</p> 	<p>Slide-Out Toppers</p> 	<p>Rear View Monitor Camera</p> 
---	--	--	---

* Slide Out Toppers N/A on select models

See the DUTCHMEN® Construction Advantage.

We put a great amount of thought into every RV we design and build. From strong frames, to sturdy walls and insulation, we build every RV to take you on many adventures to come.

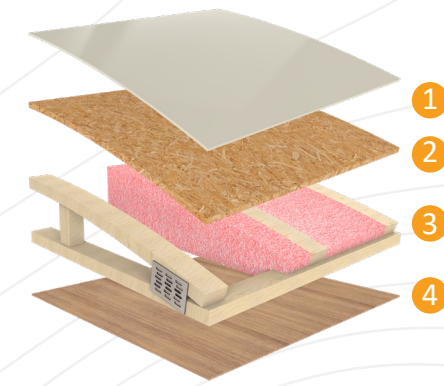

Durable Roof Structure

- 1 TPO Roof - Lifetime Warranty
- 2 3/8" Decking
- 3 Fiberglass Insulation
- 4 Luan Interior Panel



Insulated Structure

- 1 Metal Exterior Panel
- 2 Wood Frame with R7 Thermal Insulation
- 3 Luan Interior Panel

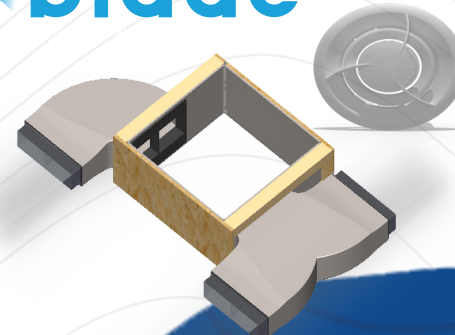
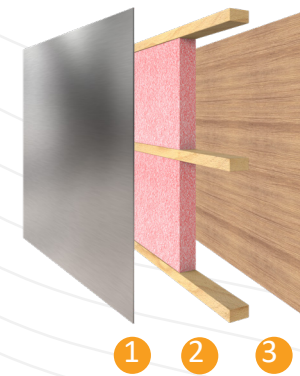

Blade Air Flow System

This design reduces air turbulence and noise accelerating airflow with duct elbows and wyes that feature enlarged inlets and narrow as they push cooled air from the AC through the length of the ducting.

(On Ducted AC Models Only)

MORE STANDARD FEATURES MORE VALUE THIS IS THE SOUL OF RVING

We've built a reputation for bringing RV owners more standard features for less money for more than 35 years, and it's a reputation we plan to keep.



100% Pre-Delivery Inspection



The Industry's Best RV Warranty



The Leader in Parts & Service



Dutchmen 35TH ANNIVERSARY

Dutchmen began in 1988, this model year we are celebrating our 35th Anniversary. Our long term success comes from never losing focus on our core mission "We work for the customer".

Everything we put into our Aspen Trail is designed not only to help you hit the road in comfort and style, but to also help you make memories with family, friends, and fellow travelers along the way.



ASPEN TRAIL WEST COAST

To learn more visit our website dutchmen.com

Length is defined as the distance from the centerline of hitch pin/coupler to rear bumper of trailer. **Our weights represent how most units are built, inclusive of many commonly-ordered options. ***Fresh water capacity includes water heater capacity.

DISCLAIMER: Product information is as accurate as possible as of the date of brochure publication. All features, floor plans and specifications in this brochure are subject to change without notice. Please consult Dutchmen's website at www.Dutchmen.com for current product information and specifications. Tow Vehicle Disclaimer. CAUTION: Owners of Dutchmen recreational vehicles are solely responsible for the selection and proper use of tow vehicles. All customers should consult with a motor vehicle manufacturer or their dealer concerning the purchase and use of suitable tow vehicles for Dutchmen products. Dutchmen disclaims any liability or damages suffered as a result of the selection, operation, use or misuse of a tow vehicle. DUTCHMEN'S LIMITED WARRANTY DOES NOT COVER DAMAGE TO THE RECREATIONAL VEHICLE OR THE TOW VEHICLE AS A RESULT OF THE SELECTION, OPERATION, USE OR MISUSE OF THE TOW VEHICLE. REFERENCE DUTCHMEN MANUFACTURING OWNERS MANUAL FOR LIMITED WARRANTY DETAILS. © 2022 Dutchmen 11-05-2022-Aspen Trail-West Coast-Printed in U.S.A MY2023

Your Dealer

PO BOX 2000 | 2164 CARAGANA COURT | GOSHEN, IN 46527 | SALES 574.537.0600



dutchmen.com

Visit us online to see all the Dutchmen brands, innovative models, and spacious floor plans.



Travel Trailers

Make Every Journey Your Own



Standard Features In Every Floorplan



Soul of the RV

Whether a weekend getaway or an extended season, the Aspen Trail will renew your spirit. With more standard features and a focus on quality, value, and design, find your soul of the RV.

EXTERIOR FEATURES:

- Solar Power Prep
- Power Stabilizers
- Power Awning w/ LED Lights
- Mega Pass Thru Storage Compartment w/LED Light
- Smooth Metal Front End
- Diamond Plate Rock Guard
- Radial Tires
- Aluminum Entry Steps (Main Entry Only)
- Outside Shower
- Black Tank Flush

INTERIOR FEATURES:

- Residential Queen Bed
- Upgraded Beauflor Lino
- LED Interior Lighting
- Central Command Center
- Seamless Countertops
- 3 Burner Range w/ Oven & Glass Cover
- High Rise Faucet
- Range Hood w/ Light & Exhaust Fan
- Stainless Steel Single Bowl Farm Sink
- Microwave
- 7 cu. ft. Gas/Electric Refrigerator
- High Output Furnace
- 13,500 BTU Ducted Air
- Foot Flush Toilet

INTERIOR DECORS



Choose how your next adventure unfolds.



ASPEN TRAIL 1900RBWE
Length: 24' 8" Weight: 4,192 lbs. Sleeps: 2-4
Hitch: 502 lbs. Height: 10' 8"



ASPEN TRAIL 2150RDWE
Length: 25' 5" Weight: 4,270 lbs. Sleeps: 4-6
Hitch: 528 lbs. Height: 11' 3"



ASPEN TRAIL 2340BHSWE
Length: 27' 8" Weight: 5,601 lbs. Sleeps: 4-6
Hitch: 605 lbs. Height: 11' 2"



ASPEN TRAIL 2050QBWE
Length: 24' 10" Weight: 4,177 lbs. Sleeps: 3-4
Hitch: 446 lbs. Height: 10' 6"



ASPEN TRAIL 2180RDWE
Length: 25' 5" Weight: 4,270 lbs. Sleeps: 4-6
Hitch: 528 lbs. Height: 11' 3"



ASPEN TRAIL 2390RKSWE
Length: 27' 4" Weight: 5,602 lbs. Sleeps: 4-6
Hitch: 598 lbs. Height: 11' 4"



ASPEN TRAIL 2550RKSWE
Length: 27' 2" Weight: 5,538 lbs. Sleeps: 4-6
Hitch: 609 lbs. Height: 11' 4"



ASPEN TRAIL 2850BHSWE
Length: 32' 9" Weight: 6,687 lbs. Sleeps: 6-8
Hitch: 713 lbs. Height: 11' 3"



ASPEN TRAIL 2880RKSWE
Length: 33' 1" Weight: 6,625 lbs. Sleeps: 4-6
Hitch: 901 lbs. Height: 11' 2"



ASPEN TRAIL 2810BHSWE
Length: 32' 6" Weight: 6,344 lbs. Sleeps: 8-10
Hitch: 825 lbs. Height: 11' 4"



ASPEN TRAIL 2860RKSWE
Length: 32' 9" Weight: 6,598 lbs. Sleeps: 4-6
Hitch: 776 lbs. Height: 11' 3"

Standard Features In Every Aspen Trail LE Floor Plan



* Not all features available on Single Axle Models

Aspen Trail LE Series



ASPEN TRAIL LE 24BHW
Length: 32' 6" Weight: 6,501 lbs. Sleeps: 4-6
Hitch: 738 lbs. Height: 11' 3"



ASPEN TRAIL LE 29BHW
Length: TBD Weight: TBD. Sleeps 10-12
Hitch: TBD Height: 11' 2"



ASPEN TRAIL LE 26BHW
Length: 32' 11" Weight: 6,625 lbs. Sleeps: 4-6
Hitch: 901 lbs. Height: 11' 2"

- **Aspen Trail Power Package** - Aspen Trail Power Stabilizers, Power Awning and Power Tongue Jack make setting up and breaking down your campsite a breeze.
- **Larger Refrigerator** - large 7 cu. ft. gas/electric refrigerator to store all your essentials with less trips to the store.

EXTERIOR FEATURES:

- High Output Furnace
- 6 Gallon Gas Water Heater
- Front & Rear Electric Jacks
- 13,500 Roof Mount A/C
- Backup Camera Prep
- Solar Prep
- Spare Tire
- 35 Amp Converter
- 30 Amp Power Cord
- Power Awning w/ LED Lights
- Power Stabilizer Jacks
- Power Tongue Jack

INTERIOR FEATURES:

- 3 Burner Range (Select Models)
- Galley Sink w/ High Rise Faucet
- 7 cu. ft. Gas/Electric Refrigerator
- Full Extension Drawer Guides Throughout
- LED Interior Lighting
- Upgraded Residential Flooring
- AM/FM/MP3 Player



Visit dutchmen.com for 360 views

*All information & specifications are for units manufactured after 10/15/2022