

Soul of the RV

Whether a weekend getaway or an extended season, the Aspen Trail will renew your spirit. With more standard features and a focus on quality, value, and design, find your soul of the RV.



35 YEARS ANNIVERSARY PACKAGE

Solo OneControl

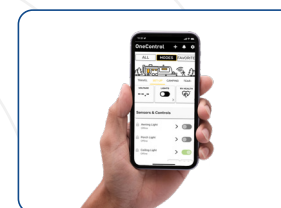

On-Demand Tankless Water Heater



Slide-Out Toppers



* Slide Out Toppers N/A on select models

Rear View Monitor Camera



INTERIOR DECORS



To learn more visit our website dutchmen.com

See the DUTCHMEN® Construction Advantage.

We put a great amount of thought into every RV we design and build. From strong frames, to sturdy walls and insulation, we build every RV to take you on many adventures to come.

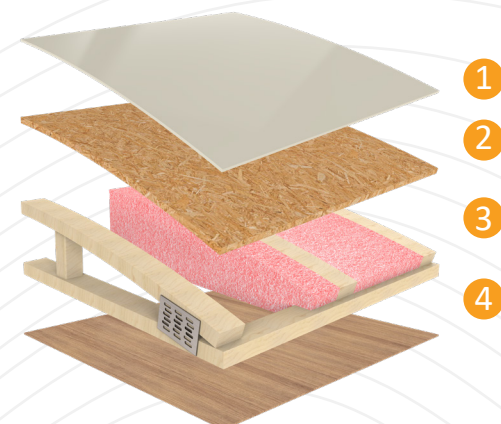

Durable Roof Structure

- 1 TPO Roof - Lifetime Warranty
- 2 3/8" Decking
- 3 Fiberglass Insulation
- 4 Lauan Interior Panel

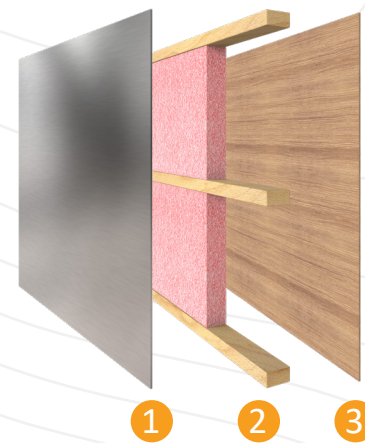

Insulated Structure

- 1 Metal Exterior Panel
- 2 Wood Frame with R7 Thermal Insulation
- 3 Lauan Interior Panel

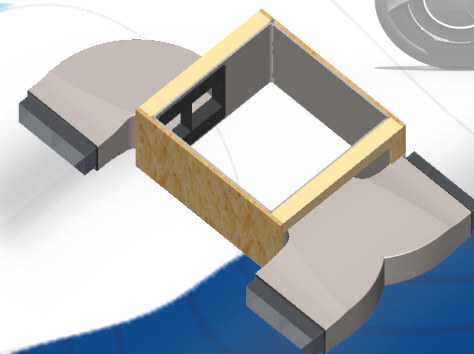

Blade Air Flow System
This design reduces air turbulence and noise accelerating airflow with duct elbows and wyes that feature enlarged inlets and narrow as they push cooled air from the AC through the length of the ducting.

(On Ducted AC Models Only)

MORE STANDARD FEATURES MORE VALUE THIS IS THE SOUL OF RVING

We've built a reputation for bringing RV owners more standard features for less money for more than 35 years, and it's a reputation we plan to keep.



100% Pre-Delivery Inspection



The Industry's Best RV Warranty



The Leader in Parts & Service



Dutchmen
35TH ANNIVERSARY

Dutchmen began in 1988, this model year we are celebrating our 35th Anniversary. Our long term success comes from never losing focus on our core mission "We work for the customer".

Everything we put into our Aspen Trail is designed to help you make memories with family, friends, and fellow travelers along the way.

Your Dealer

PO BOX 2000 | 2164 CARAGANA COURT | GOSHEN, IN 46527 | SALES 574.537.0600

www.dutchmen.com

Visit us online to see all the Dutchmen brands, innovative models and spacious floor plans.



ASPEN TRAIL



Travel Trailers

Make Every Journey Your Own



*Length is defined as the distance from the centerline of hitch pin/coupler to rear bumper of trailer. **Our weights represent how most units are built, inclusive of many commonly-ordered options. ***Fresh water capacity includes water heater capacity. DISCLAIMER: Product information is as accurate as possible as of the date of brochure publication. All features, floor plans and specifications in this brochure are subject to change without notice. Please consult Dutchmen's website at www.Dutchmen.com for current product information and specifications. **Tow Vehicle Disclaimer.** CAUTION: Owners of Dutchmen recreational vehicles are solely responsible for the selection and proper use of tow vehicles. All customers should consult with a motor vehicle manufacturer or their dealer concerning the purchase and use of suitable tow vehicles for Dutchmen products. Dutchmen disclaims any liability or damages suffered as a result of the selection, operation, use or misuse of a tow vehicle. DUTCHMEN'S LIMITED WARRANTY DOES NOT COVER DAMAGE TO THE RECREATIONAL VEHICLE OR THE TOW VEHICLE AS A RESULT OF THE SELECTION, OPERATION, USE OR MISUSE OF THE TOW VEHICLE. REFERENCE DUTCHMEN MANUFACTURING OWNERS MANUAL FOR LIMITED WARRANTY DETAILS. © 2022 Dutchmen 11-2023-ASPEN-TRAIL-Printed in U.S.A. MY2023

ASPEN TRAIL

Aspen Trail has the most dynamic range of floor plan options to fit any camping style. With more standard features than its competitors and a focus on quality, value, and design, Aspen Trail delivers the best RV in its class. Whether your trail leads across this great country or simply a staycation, with Aspen Trail make every journey your own.

- **Aspen Trail Power Package** - Aspen Trail Power Stabilizers, Power Awning and Power Tongue Jack make setting up and breaking down your campsite a breeze.
- **Fully Enclosed Underbelly** - all of your RV's vital functions are kept out of the elements. Plus, this extra layer of protection means you can travel further into the year.
- **Aluminum Steps** - stability you need when coming and going from your Aspen Trail. Easy to expand and store away, these aluminum steps deliver a sound platform.



SOLO ONEControl

The SOLO ONE Control allows complete control over many of your RV's most important functions through a mobile app.

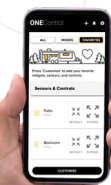

- ✓ Slide-outs
- ✓ Awnings
- ✓ Lights
- ✓ Tank Monitor



Choose how your next adventure unfolds.



ASPEN TRAIL 2260RBS
Length: 26' 11" Weight: 5,664 lbs. Sleeps: 2-4
Hitch: 574 lbs. Height: 11' 3"

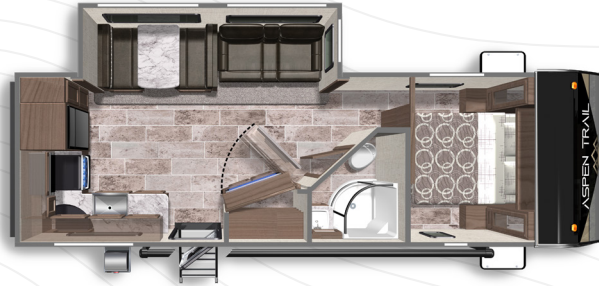

ASPEN TRAIL 2560RKS*
Length: 29' 9" Weight: 6,346 lbs. Sleeps: 2-4
Hitch: 793 lbs. Height: 11' 3"



ASPEN TRAIL 2850BHS
Length: 32' 9" Weight: 6,535 lbs. Sleeps: 6-8
Hitch: 729 lbs. Height: 11' 3"



ASPEN TRAIL 2880RKS
Length: 32' 11" Weight: 6,625 lbs. Sleeps: 4-6
Hitch: 679 lbs. Height: 11' 2"



ASPEN TRAIL 2550BHS
Length: 29' 6" Weight: 5,930 lbs. Sleeps: 2-4
Hitch: 621 lbs. Height: 11' 3"



ASPEN TRAIL 2790BHS
Length: 31' 11" Weight: 6,577 lbs. Sleeps: 6-8
Hitch: 639 lbs. Height: 11' 3"



ASPEN TRAIL 2860RLS
Length: 32' 6" Weight: 6,535 lbs. Sleeps: 4-6
Hitch: 734 lbs. Height: 11' 3"



ASPEN TRAIL 2910BHS
Length: 33' 1" Weight: 6,539 lbs. Sleeps: 8-10
Hitch: 786 lbs. Height: 11' 3"



ASPEN TRAIL 3020BHS
Length: 34' 6" Weight: 7,048 lbs. Sleeps: 6-8
Hitch: 909 lbs. Height: 11' 4"



ASPEN TRAIL 3120BHS
Length: 35' 1" Weight: 7,002 lbs. Sleeps: 8-10
Hitch: 884 lbs. Height: 11' 3"

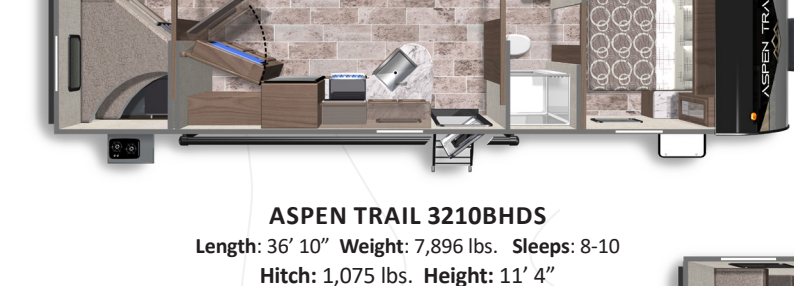

ASPEN TRAIL 3210BHS
Length: 36' 10" Weight: 7,896 lbs. Sleeps: 8-10
Hitch: 1,075 lbs. Height: 11' 4"



ASPEN TRAIL 3280BHS
Length: 36' 3" Weight: 7,190 lbs. Sleeps: 8-10
Hitch: 1,110 lbs. Height: 11' 6"



ASPEN TRAIL 3230BHS
Length: 36' 3" Weight: 8,098 lbs. Sleeps: 10-12
Hitch: 992 lbs. Height: 11' 3"



Visit dutchmen.com for 360 views



ASPEN TRAIL 3120BHS
Length: 35' 1" Weight: 7,002 lbs. Sleeps: 8-10
Hitch: 884 lbs. Height: 11' 3"



ASPEN TRAIL 3280BHS
Length: 36' 3" Weight: 7,190 lbs. Sleeps: 8-10
Hitch: 1,110 lbs. Height: 11' 6"

i To see more, visit dutchmen.com

Standard features in every floorplan



EXTERIOR FEATURES:

- Mega Pass Through Storage Compartment w/ LED Light
- Roof Solar Power Prep w/Inverter Prep
- Aluminum Entry Steps (Main Entry Only)
- Diamond Plate Rock Guard
- Power Awning w/ LED Light
- Black Tank Flush
- Outside Shower
- Power Stabilizers
- Smooth Metal Front End
- Fully Enclosed Underbelly
- 60,000 BTU On -Demand Water Heater
- Black Tank Flush
- Solid Step Entry Steps
- Smooth Front Metal
- Front & Rear Stabilizer Jacks

INTERIOR FEATURES:

- Residential Queen Bed
- Bedroom Night Stands w/Drawers
- Seamless Countertops
- High Rise Faucet
- 3 Burner Range w/ Oven and Glass Cover
- Microwave
- Stainless Steel Single Bowl Farm Sink
- 10 cu. ft. 12 V Refrigerator / Optional 8 cu. ft. Gas/Electric Refrigerator
- Range Hood w/ Light and Exhaust Fan
- Blackout Roller Shades in Slide Out
- LED Fireplace w/Electric Heat*
- 15,000-BTU A/C - Standard on ALL Models
- High Output Furnace
- Hardwood Cabinetry Throughout
- Convertible U-Shape Dinette*
- Roller Shades
- 82" Interior Height



*Select Models

*All information & specifications are for units manufactured after 12/15/2022

Not all features available on select floorplans. See Dealer for details.